

PARCEL MAP No. 2479

BOUNDARY LINE ADJUSTMENT

for
RICK WISE and VICTORIA WISE
2019-0000466

BEING AN ADJUSTMENT OF LOTS 20 AND 21, BLOCK 1, AMADOR CITY
ALSO BEING A PORTION OF THE N 1/2 SECTION 36, T. 7 N., R. 10 E., M. D. M.
CITY OF AMADOR CITY, COUNTY OF AMADOR, STATE OF CALIFORNIA

OWNER'S CERTIFICATE

THE UNDERSIGNED HEREBY CERTIFY THAT WE ARE THE OWNERS OF REAL PROPERTY SHOWN
HEREON AND DO HEREBY CONSENT TO THE PREPARATION AND RECORDATION OF THIS MAP.

Rick Wise
RICK WISE

Victoria Wise
VICTORIA WISE

TOMA & ASSOCIATES INC.
ENGINEERING - SURVEYING - PLANNING
41 Summit Street, Jackson, CA 95642
(209) 223-0156

October, 2020

NOTARY'S STATEMENT

A NOTARY PUBLIC OR OTHER OFFICER COMPLETING THIS CERTIFICATE VERIFIES ONLY THE IDENTITY OF
THE INDIVIDUAL WHO SIGNED THE DOCUMENT TO WHICH THIS CERTIFICATE IS ATTACHED, AND NOT THE
TRUTHFULNESS, ACCURACY, OR VALIDITY OF THAT DOCUMENT.

STATE OF CALIFORNIA
COUNTY OF Amador

ON December 2, 2020 BEFORE ME, Sarah Zulin, NOTARY PUBLIC,
PERSONALLY APPEARED Rick Wise and Victoria Wise
WHO PROVED TO ME ON THE BASIS OF SATISFACTORY EVIDENCE TO BE THE PERSON(S) WHOSE
NAME(S) IS/ARE SUBSCRIBED TO THE WITHIN INSTRUMENT AND ACKNOWLEDGED TO ME THAT
HE/SHE/THEY EXECUTED THE SAME IN HIS/HER/THEIR AUTHORIZED CAPACITY(IES) AND THAT BY
HIS/HER/THEIR SIGNATURE(S) ON THE INSTRUMENT, THE PERSON(S) OR ENTITY UPON BEHALF OF
WHICH THE PERSON(S) ACTED, EXECUTED THE INSTRUMENT.

I CERTIFY UNDER PENALTY OF PERJURY UNDER THE LAWS OF THE STATE OF CALIFORNIA THAT
THE FOREGOING PARAGRAPH IS TRUE AND CORRECT.

SIGNATURE: [Signature] NAME: Sarah Zulin
COUNTY: Amador COMM. EXP.: September 30, 2021

NOTARY'S STATEMENT

A NOTARY PUBLIC OR OTHER OFFICER COMPLETING THIS CERTIFICATE VERIFIES ONLY THE IDENTITY OF
THE INDIVIDUAL WHO SIGNED THE DOCUMENT TO WHICH THIS CERTIFICATE IS ATTACHED, AND NOT THE
TRUTHFULNESS, ACCURACY, OR VALIDITY OF THAT DOCUMENT.

STATE OF CALIFORNIA
COUNTY OF _____

ON _____, BEFORE ME, _____, NOTARY PUBLIC,
PERSONALLY APPEARED _____
WHO PROVED TO ME ON THE BASIS OF SATISFACTORY EVIDENCE TO BE THE PERSON(S) WHOSE
NAME(S) IS/ARE SUBSCRIBED TO THE WITHIN INSTRUMENT AND ACKNOWLEDGED TO ME THAT
HE/SHE/THEY EXECUTED THE SAME IN HIS/HER/THEIR AUTHORIZED CAPACITY(IES) AND THAT BY
HIS/HER/THEIR SIGNATURE(S) ON THE INSTRUMENT, THE PERSON(S) OR ENTITY UPON BEHALF OF
WHICH THE PERSON(S) ACTED, EXECUTED THE INSTRUMENT.

I CERTIFY UNDER PENALTY OF PERJURY UNDER THE LAWS OF THE STATE OF CALIFORNIA THAT
THE FOREGOING PARAGRAPH IS TRUE AND CORRECT.

SIGNATURE: _____ NAME: _____
COUNTY: _____ COMM. EXP.: _____

CITY CLERK'S CERTIFICATE

I, JOYCE DAVIDSON, HEREBY CERTIFY THAT THE CITY COUNCIL OF AMADOR CITY, CALIFORNIA,
HAS APPROVED THE BOUNDARY LINE ADJUSTMENT FOR RICK AND VICTORIA WISE BY
RESOLUTION No. 568 DATED APRIL 19, 2020.

DATE: December 10, 2020

Joyce Davidson
JOYCE DAVIDSON
AMADOR CITY CLERK

SURVEYOR'S STATEMENT

THIS SURVEY WAS PREPARED BY ME OR UNDER MY DIRECTION AND IS BASED UPON A
FIELD SURVEY IN CONFORMANCE WITH THE REQUIREMENTS OF THE SUBDIVISION MAP ACT
AND LOCAL ORDINANCE AT THE REQUEST OF RICK WISE IN JULY OF 2020. I HEREBY
STATE THAT THIS PARCEL MAP SUBSTANTIALLY CONFORMS TO THE APPROVED LOT LINE
ADJUSTMENT, THAT THE MONUMENTS ARE OF THE CHARACTER AND OCCUPY THE
POSITIONS INDICATED, AND THAT SAID MONUMENTS ARE SUFFICIENT TO ENABLE THE SURVEY
TO BE RETRACED.

DATE: November 24, 2020

[Signature]
CIRO L. TOMA P.L.S. 3570
MY LICENSE EXPIRES 6-30-2022

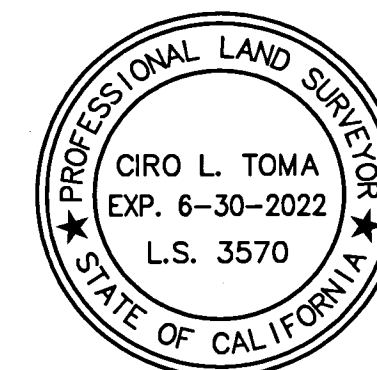

CITY ENGINEER'S STATEMENT

I HAVE EXAMINED THIS PARCEL MAP. THE SUBDIVISION AS SHOWN HEREON IS
SUBSTANTIALLY THE SAME AS IT APPEARED ON THE APPROVED LOT LINE ADJUSTMENT.
ALL PROVISIONS OF THE SUBDIVISION MAP ACT AND LOCAL ORDINANCE HAVE BEEN
COMPLIED WITH. I AM SATISFIED THE MAP IS TECHNICALLY CORRECT.

DATE: 12.14.2020

[Signature]
ROARK WEBER R.C.E. 22295
AMADOR CITY ASSOCIATE CITY ENGINEER
MY LICENSE EXPIRES 9-30-2021



RECORDER'S STATEMENT

FILED THIS 31st DAY OF December, 2020 AT 2:48 P.M.
IN BOOK 66 OF MAPS AND PLATS AT PAGE 63 AT THE REQUEST OF
THE AMADOR CITY CLERK.

FEE: \$15⁰⁰ pd/fild

INSTRUMENT No.: 2020-0012465

Kimberly L. Grady
KIMBERLY L. GRADY
AMADOR COUNTY RECORDER

BY: [Signature]
DEPUTY