

Swamp and Overflowed Lands.

Survey No. 177.

Township 3 South.

Range 7 East.

Sections 20, 21, 29.

The  $\frac{1}{2}$  of S.E.  $\frac{1}{4}$  of section 20,  
and fractional  $\frac{1}{2}$  of S.W.  $\frac{1}{4}$  section 21,  
fractional N.E.  $\frac{1}{4}$  of section 29.

Base and Meridian of Mt Diablo.

Containing 278,444 Acres,  
Surveyed Oct 28<sup>th</sup> 1862,

For Elam F. Grewell.

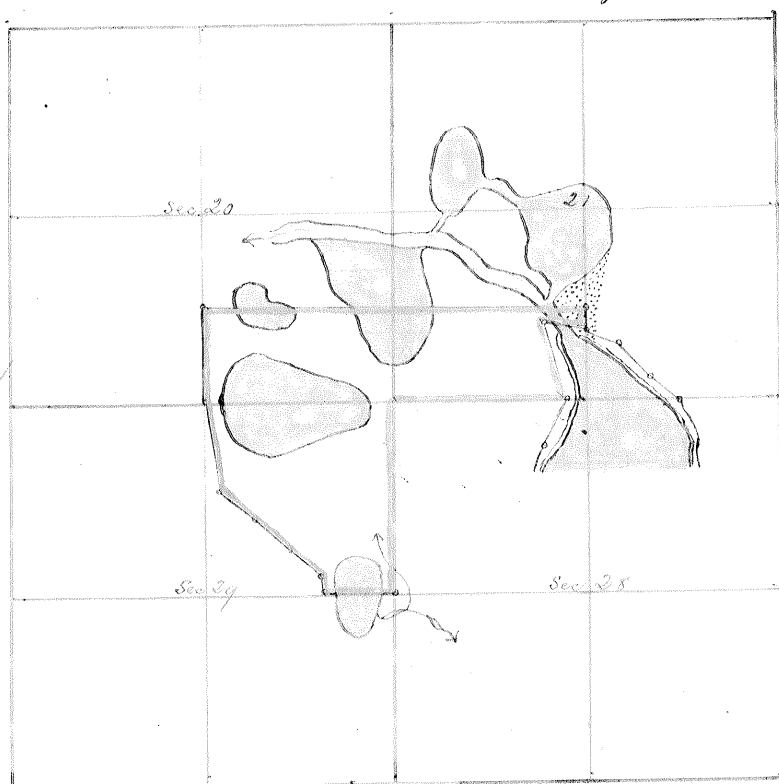

### Field Notes.

Beginning at the common corner of Sections 20, 21, 28, + 29  
Township 3, Range south, 7 East, Mt Diablo Meridian, and running  
thence East 36,40 chains to intersection with U.S. meander line on  
west bank of Lake, thence with said U.S. meander line  $N 15^{\circ} W$ , 16,90  
chains,  $S 69^{\circ} E$  8,63 ch, to intersection with  $N + S \frac{1}{4}$  section line in Sec.  
21, thence north with said  $\frac{1}{4}$  section line 6,78 chains to a point  
at intersection of line between the  $N \frac{1}{2}$  and  $S \frac{1}{2}$  of the S.W.  $\frac{1}{4}$  of  
section 21, thence west 80 chains to intersection with  $N + S \frac{1}{4}$  section  
line in section 20, thence south 20 chains, thence with U.S. meander  
line  $S 7 \frac{1}{4}^{\circ} E$  19,20 ch,  $S 51 \frac{1}{4}^{\circ} E$  19 ch,  $S 48 \frac{1}{2}^{\circ} E$  9 ch,  $S \frac{1}{2}^{\circ} W$  3,10 ch, to intersection  
of  $E + W \frac{1}{4}$  section line in section 28, thence east 15,95 chains to  
intersection of section line between sections 28 + 29, thence North  
40 chains to point of beginning.

Run by the true Meridian, Magnetic Variation  $15^{\circ} 45'$  E.

Surveyed in accordance with the Act of the Legislature  
concerning Swamp and Overflowed Lands, approved April 18<sup>th</sup>  
1859, and the instruction of the Surveyor General.

E. V. Beard  
Co. Surveyor Stanislaus Co.  
By A. J. Stokes  
Deputy