

CORNER RECORD

Agency Index BK 129 PG 17
Document Number CR 12914

City of Berkeley (APN 55-1853-19) County of Alameda, California
Brief Legal Description Monument near 70 Panoramic Way

CORNER TYPE

COORDINATES (Optional)

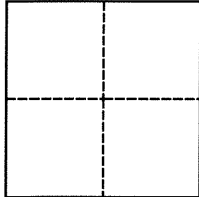

Government Corner ☐ Control ☒
Meander ☐ Property ☐
Rancho ☐ Other ☐

N. _____ E. _____

Elevation _____

Units Metric ☐ U.S. Survey Foot ☐

Horizontal Datum _____

Zone _____ Epoch Date _____

Date of Survey January 29, 2019

Vertical Datum _____

☐ Complies with Public Resources Code §§8801-8819

☐ Complies with Public Resources Code §§8890-8902

PLS Act Ref.: ☐ 8765(d) ☒ 8771 ☐ 8773 ☐ Other:
Corner/Monument: ☒ Left as found ☐ Established ☐ Rebuilt ☐ Pre-Construction
☐ Found and tagged ☐ Reestablished ☒ Referenced ☒ Post-Construction

Narrative of corner identified and monument as found, set, reset, replaced, or removed:

☒ See sheet #2 for description(s):

City monument was referenced prior to pipeline construction per CR 7933. Monument was checked on January 29, 2019 by an EBMUD survey crew, and found undisturbed and in good condition. See sheet 2.

Reference EBMUD Field Book 4540, Page 67 (Clarke/Baumann)

SURVEYOR'S STATEMENT

This Corner Record was prepared by me or under my direction in conformance with
the Professional Land Surveyors' Act on DECEMBER 4, 2019.

Signed James M. Mangini P.L.S. or R.C.E. No. 7263

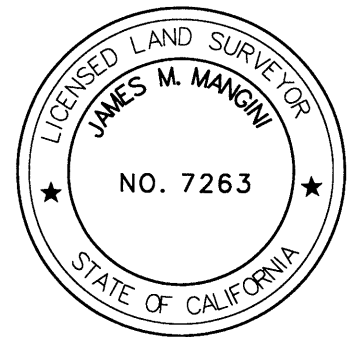

COUNTY SURVEYOR'S STATEMENT

This Corner Record was received December 4, 2019
and examined and filed DEC 11 2019.

Signed D. Ian Wilson P.L.S. or R.C.E. No. 7010

Title County Surveyor

County Surveyor's Comment



ALAMEDA COUNTY

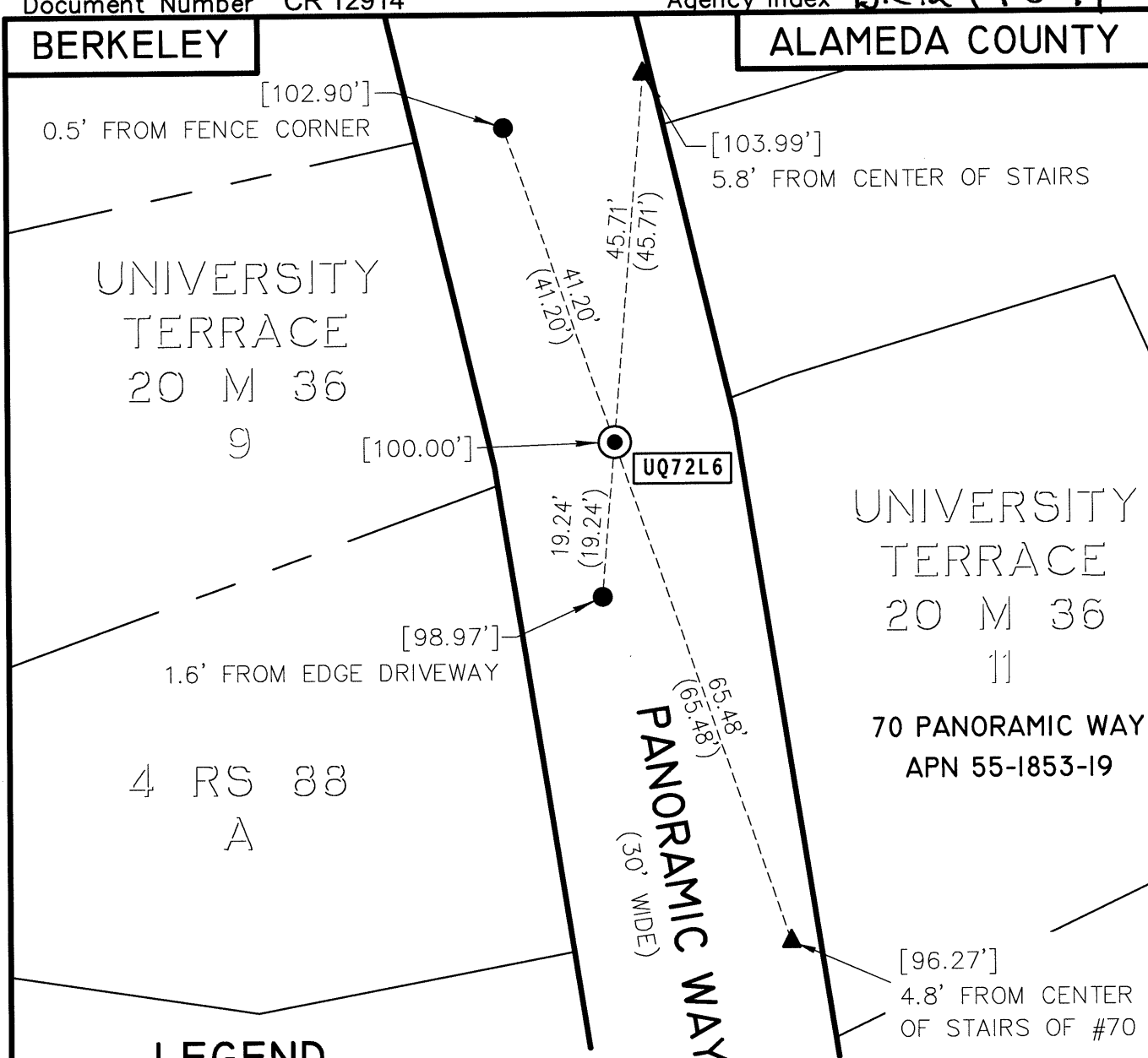

FOUND 3/4" IRON PIN, DOWN 0.3' IN MONUMENT WELL, PER CR 7933

- ▲ FOUND MAG NAIL, IN TOP OF CONCRETE CURB, PER CR 7933
- FOUND CONCRETE ANCHOR NAIL AND 1-1/2" ALUMINUM WASHER, STAMPED "EBMUD MON RP" IN TOP OF CONCRETE CURB, PER CR 7933

[] ASSUMED ELEVATION (MEASURED USING A LEICA DNA10 DIGITAL LEVEL), PER CR 7933

AA###A# ALAMEDA COUNTY MONUMENT I.D.

(19.24') RP DISTANCE PER CR 7933

ADDRESS: 70 PANORAMIC WAY

APN: 55-1853-19



SCALE
1"=20'

