

CORNER RECORD

Document Number CR 8502

City of SAN LEANDRO

County of ALAMEDA, California

Brief Legal Description LOT 88, TRACT 1734, FILED IN BOOK 38 OF MAPS, AT PAGE 11

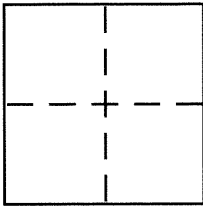

CORNER TYPE

Government Corner . Control .
Meander . Property **X**
Rancho . Other .
Date of Survey JUNE 21, 2016

COORDINATES (Optional)

N. _____
E. _____
Zone _____ NAD27 NAD83
NAD83 Epoch _____
Elev. _____
Vert. Datum: NGVD29 NAVD88
Meas. Units: Metric Imperial

Corner – Left as found Found and tagged Established **X** Reestablished Rebuilt

Identification and type of corner found: Evidence used to identify or procedure used to establish or reestablish the corner:
FOUND: STANDARD PIN MONUMENTS IN MONUMENT WELLS IN HUMBOLT DRIVE, AS SHOWN ON
TRACT 1734, PER BOOK 38 MAPS, PAGE 11.

SEE SKETCH ON PAGE 2 OF 2

A description of the physical condition of the monument as found and as set or reset:

SET: NAIL WITH 3/4" BRASS TAG "PLS 7393", AND 1/2" DIAMETER REBAR & PLASTIC CAP "PLS 7393".

SEE SKETCH ON PAGE 2 OF 2

SURVEYOR'S STATEMENT

This Corner Record was prepared by me or under my direction in conformance with
the Land Surveyor's Act on JULY 03 2016

Signed [Signature] P.L.S. or P.C.E. No. PLS 7393

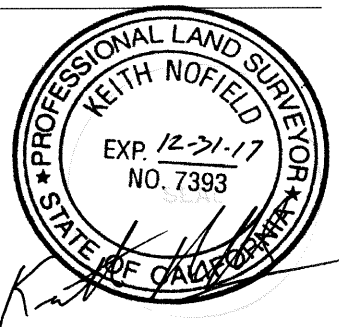

COUNTY SURVEYOR'S STATEMENT

This Corner Record was received 6 JULY, 2016

and examined and filed 18 JULY, 2016

Signed Michael Rubner P.L.S. or P.C.E. No. 6843

Title COUNTY SURVEYOR

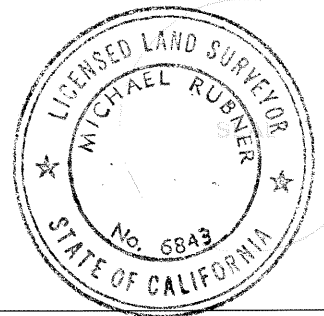

County Surveyor's Comment _____

